

# GRILLEZ

MUTO acoustic wall  
& ceiling solutions

---

SOELBERG



# GRILLEZ

## MUTO acoustic wall & ceiling solutions

Transform your walls and ceilings into an acoustic architectural masterpiece with Grillez. Featuring striking wood grain blades mounted to acoustic PET panels, Grillez brings warmth, texture and dimension to any environment while reducing noise and echo. We've made Grillez easy to specify and just as simple to install. Installed in the ceiling directly to T-grid or on the wall with Zclip hardware, choose from a variety of colors, panel lengths, blade sizes and spacing.

### SPECIFICATION

<b>MATERIAL</b>	TFL   PARTICLEBOARD   PET	
<b>CORE THICKNESS</b>	3/4" (BLADE)   1/2" (BACKER)	
<b>PANEL SIZE</b>	12" x 48" 12" x 72" 12" x 96"	24" x 48" 24" x 72" 24" x 96"
<b>BLADE HEIGHT</b>	1.5"   3"   5"	
<b>COLOR</b>	6 TFL WOOD GRAINS (BLADE) 39 PET COLORWAYS (BACKER)	
<b>ACOUSTICS</b>	0.70 - 0.95 NRC	
<b>FIRE RATING</b>	CLASS A   ASTM - E84	
<b>ENVIRONMENTAL</b>	PARTICLEBOARD CORES CONSIST OF 100% RECYCLED AND/OR RECOVERED FIBER.  DECLARE, MINDFUL MATERIALS & GREENGUARD GOLD CERTIFIED. MUTO IS PRODUCED FROM 100% RECYCLABLE PET FELT WITH A MINIMUM OF 60% PRE-CONSUMER RECYCLED CONTENT.	
<b>LEAD TIME</b>	4+ WEEKS (BASED ON STOCK AND QUANTITY)	
<b>WARRANTY</b>	2 YEARS	

### TOLERANCES, STORAGE & HANDLING

PET felt is made from 100% recyclable polyester plastic. Slight and consistent variations in color, depth, density, and texture are inherent to this core material and should be expected. Color, density and texture will vary by dye lot. MUTO is made with a 'felling' process which results in a textural heathered effect where the fibers consist of multiple tones and shades.

All dimensions and squareness are subject to a 3/16" tolerance. Grillez, like all wood products, will expand and contract nominally with fluctuations in moisture levels. Wood products have a potential expansion of +/- 0.33%. Grillez panels will grow in high humidity conditions and shrink in low level humidity conditions. Controlled environments with maintained humidity levels of 25 - 55% are recommended. Humidity below 20% or above 80% may cause panel problems.

Grillez panels should be stored flat and in an HVAC controlled environment of 65 - 75° F (18 - 24° C) with relative humidity levels of 25 - 55% for at least 48 hours prior to installation. Installation areas must be enclosed and weatherproofed before installation commences.



# HOW TO SPECIFY

It is easy to specify Grillez with four simple steps.

# 1

## CHOOSE WOOD GRAIN & PET COLOR

Select from 6 wood grains for your panel blades and 39 PET colors for your backer panel. 12 of our colors have an extended lead time.

# 2

## SELECT PANEL SIZE

Select panels from 12" and 24" widths and 48", 72" or 96" lengths.

# 3

## CHOOSE BLADE HEIGHT AND SPACING

With various blade heights and spacing options, we make Grillez almost as unique as you are.

# 4

## PROVIDE PANEL QUANTITY

Provide your panel quantity. From 1 panel to hundreds of panels, we've got you covered.

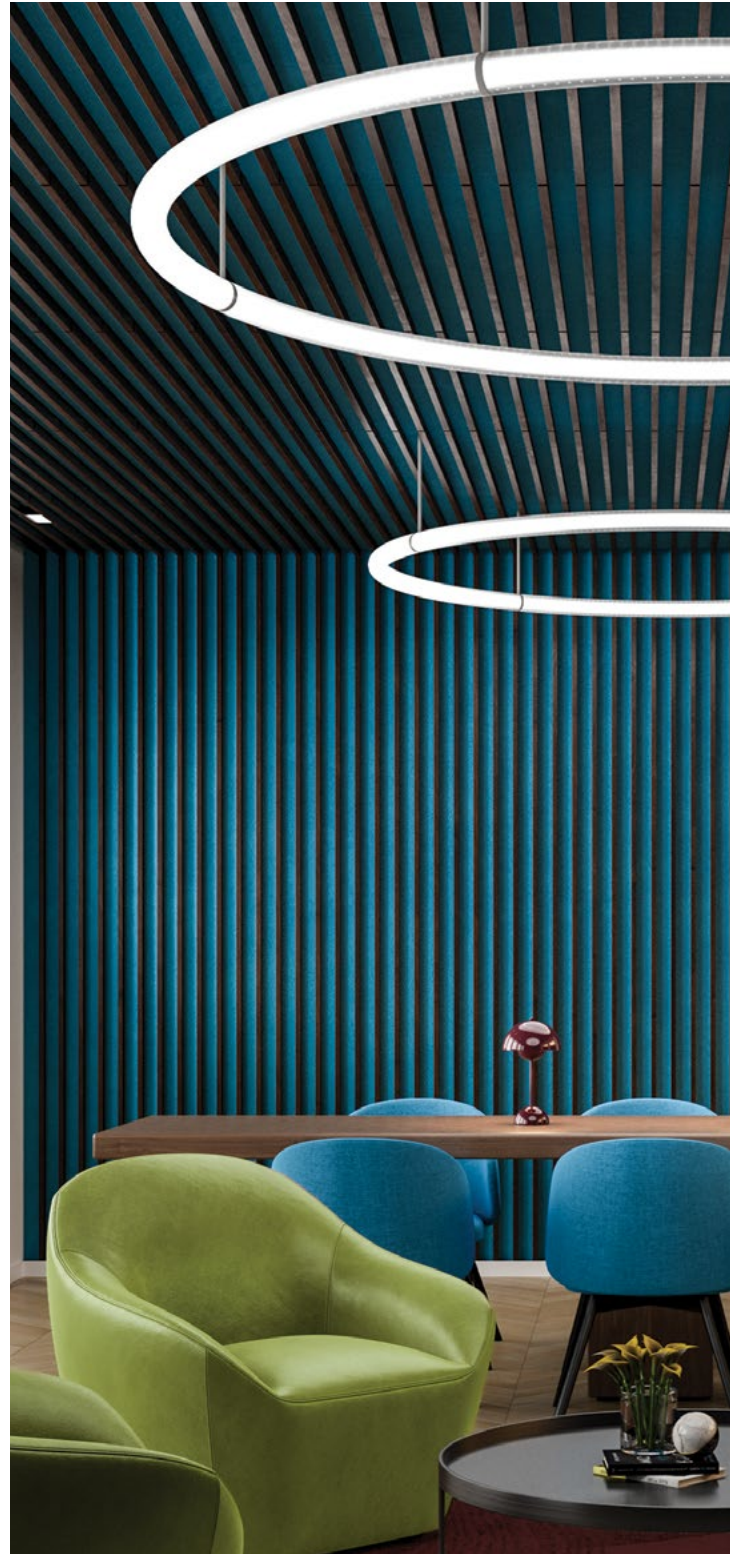

# WOOD GRAIN

## MATTE COLOR

6 STANDARD GRAINS  
CLASS A FIRE RATED  
PARTICLE BOARD CORE

\*\*\*Please request samples to verify grain color as monitors and printers vary.

## WHAT IS TFL?

What is TFL? Thermally fused laminate is made from resin-saturated paper that is fused directly to a wood composite core under very high heat and pressure. With textured wood grain options, TFL is an incredibly durable and affordable wood alternative.



DIVA



URBAN



ENDLESS ELM



CASUAL CHESTNUT



KARUNA ASH



WRIGHT WALNUT

# COLOR (STOCK)

## MATTE COLOR

27 STANDARD COLORS  
CUSTOM PRINT COLORS AVAILABLE  
(CONTACT YOUR LOCAL SALES REP)  
100% RECYCLABLE PET FELT

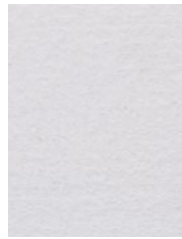

WHITE

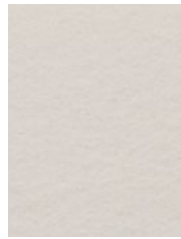

BONE

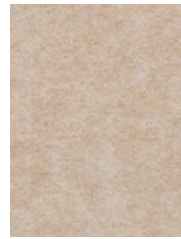

OATMEAL

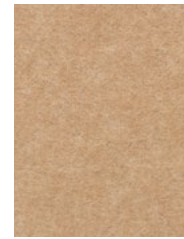

CAMEL



SAND

## TOLERANCES

PET felt is made from 100% recyclable polyester plastic. Variation in depth will occur. Slight and consistent variations in color, density, and texture are inherent to this core material and should be expected. Color, density and texture will vary by dye lot. MUTO is made with a 'felling' process which results in a textural heathered effect where the fibers consist of multiple tones and shades.



CASHMERE



FOG

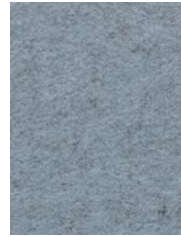

LAMB'S EAR

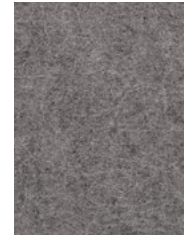

PEWTER



NORDIC KNIT

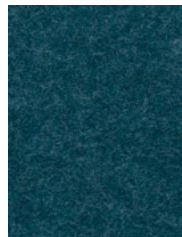

WINTER WATER

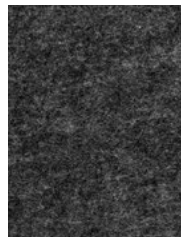

GRAPHITE



BLACK



MIDNIGHT



BLUEBERRY

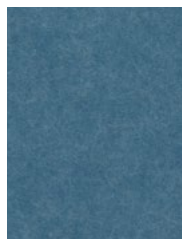

JUNIPER



SPLASH



STORM

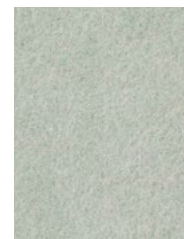

SEAFOAM



SAGE



ARTICHOKE



LICHEN



SUNSHINE

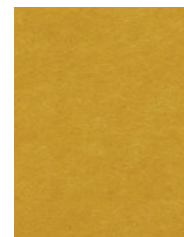

QUAKING ASPEN



CLEMENTINE



CHILI PEPPER



CURRANT

## COLOR (NON STOCK)

EXTENDED LEAD TIME

### MATTE COLOR

12 STANDARD NON-STOCKED COLORS  
CUSTOM PRINT COLORS AVAILABLE  
(CONTACT YOUR LOCAL SALES REP)  
100% RECYCLABLE PET FELT

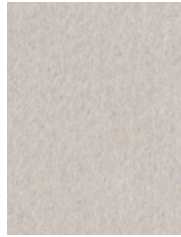

LATTE



CITY GRAY



BONDI BLUE



MARINE



WASHED DENIM

### TOLERANCES

PET felt is made from 100% recyclable polyester plastic. Variation in depth will occur. Slight and consistent variations in color, density, and texture are inherent to this core material and should be expected. Color, density and texture will vary by dye lot. MUTO is made with a 'felling' process which results in a textural heathered effect where the fibers consist of multiple tones and shades.

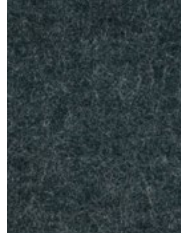

DEEP JUNGLE



COLLARD GREEN

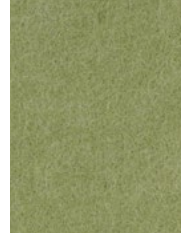

ASPARAGUS



PECAN



SIENA



RASPBERRY



PINK LEMONADE

## PANEL SIZES

### 12" x 48" or 24" x 48"

Grillez panels will always have a 1/2" reveal between the blades (1/4" top and 1/4" bottom) from panel end to end.

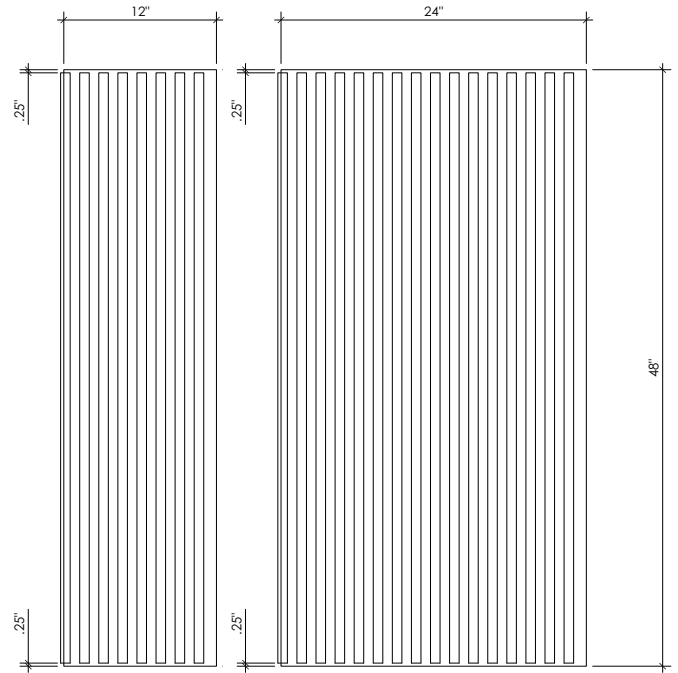

GRILLEZ 12" x 48" OR 24" x 48"

### 12" x 72" or 24" x 72"

Grillez panels will always have a 1/2" reveal between the blades (1/4" top and 1/4" bottom) from panel end to end.

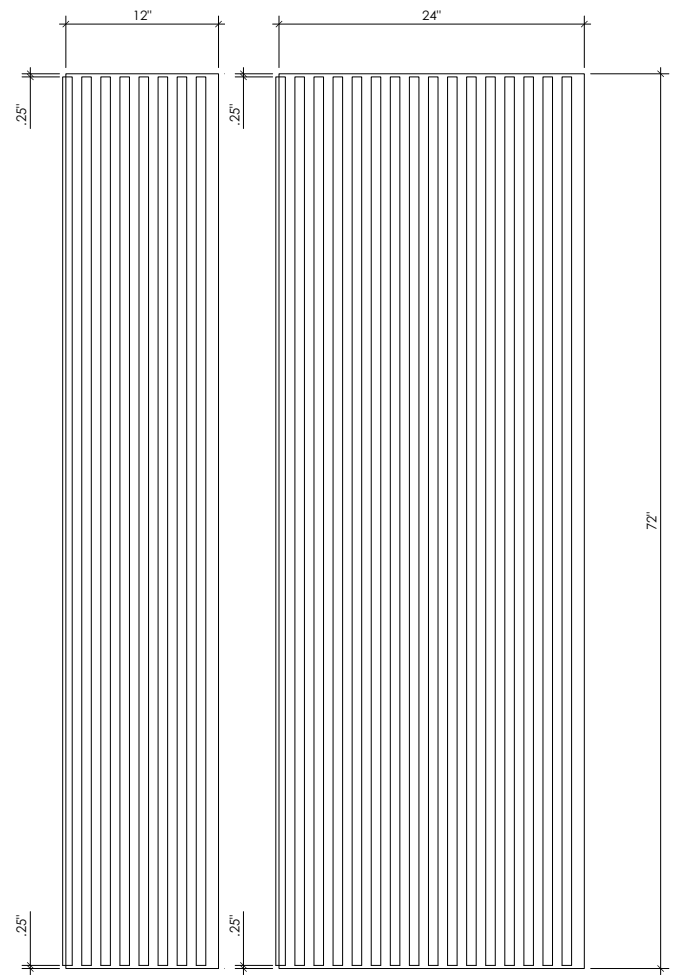

GRILLEZ 12" x 72" OR 24" x 72"

## PANEL SIZES CONTINUED

### 12" x 96" or 24" x 96"

Grillez panels will always have a 1/2" reveal between the blades (1/4" top and 1/4" bottom) from panel end to end.

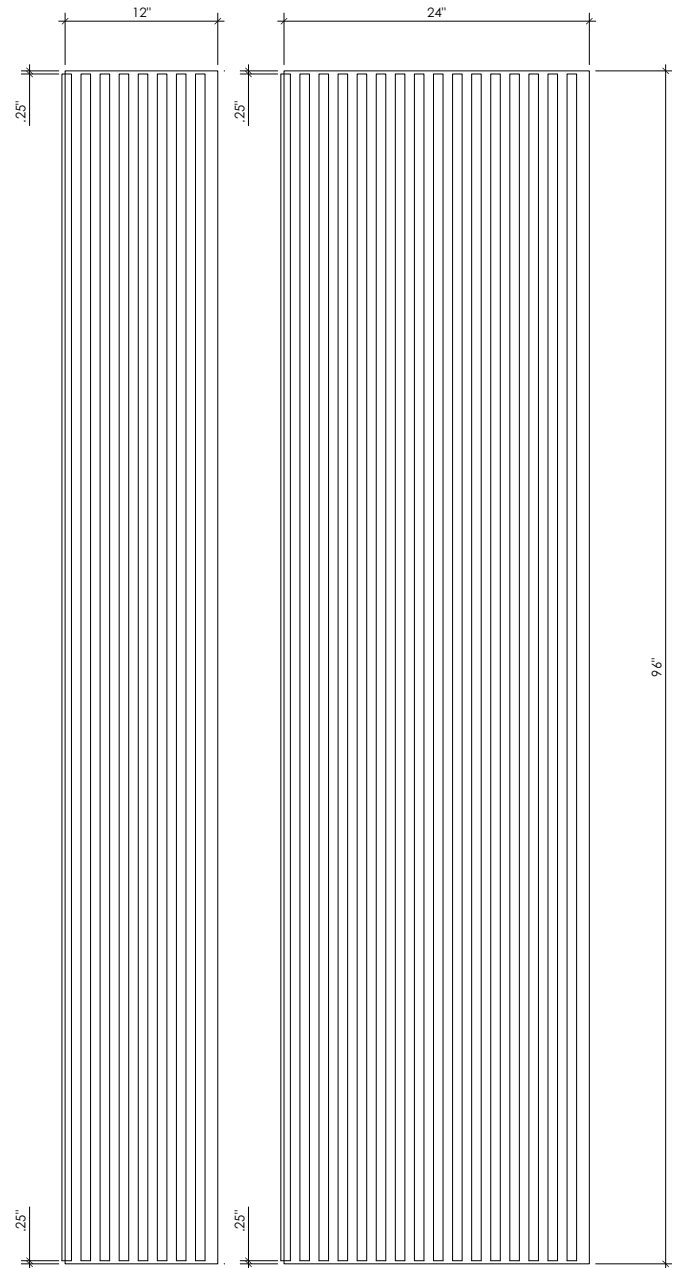

GRILLEZ 12" x 96" OR 24" x 96"

# BLADE DIMENSIONS

## BLADE HEIGHT & OC SPACING

Blade heights range from 1.5" to 5"  
Spacing ranges from 1.5" OC to 3" OC

Blade heights and spacing options available as shown.

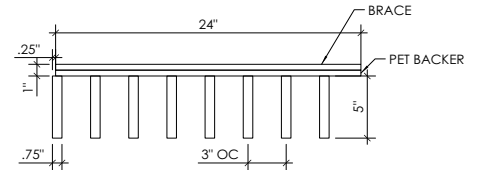
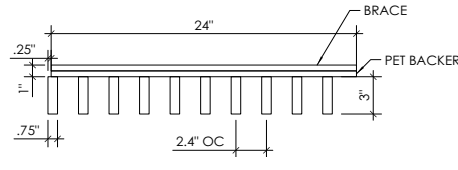
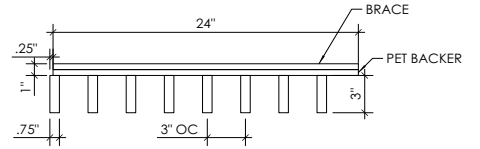
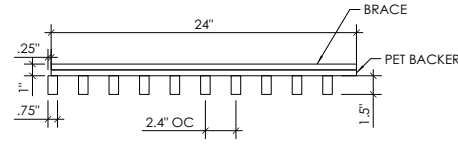
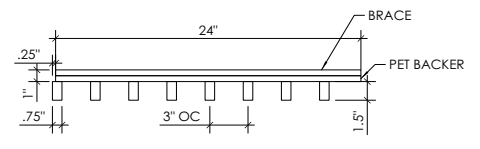
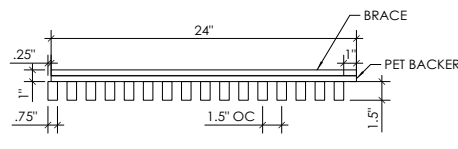
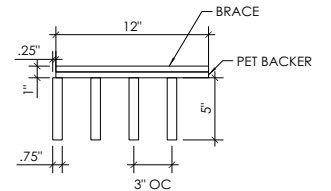
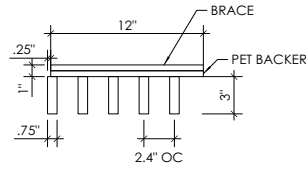
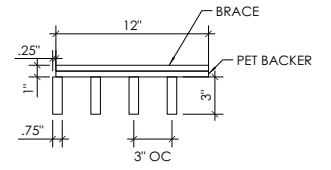
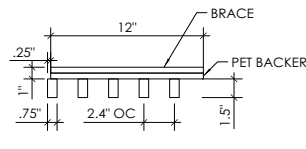
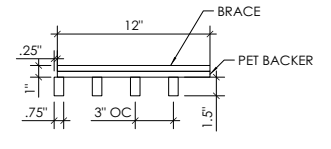
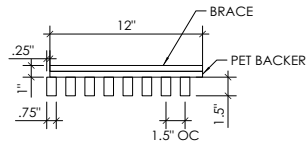

# ACOUSTICS

NRC values in the United States use the ASTM C423 for an industry-wide standard for testing acoustic baffles.

The previous test: ASTM C423-17: "Standard Test Method for Sound Absorption and Sound Absorption Coefficients by the Reverberation Room Method." has been replaced in 2023 with ASTM C423-23.

This latest version removes ambiguity regarding the surface area used to calculate the NRC values.

Previous Soelberg NRC values for hanging baffles have used ASTM C423-17 with the total sound absorption divided by the total surface area of the test surface covered by the hanging baffles, including intermediate spaces. This is more conservative than other calculation methods, but is most representative of the intended use of our baffles.

As of July 2023, Soelberg has adapted all of our NRC tests to the latest method: ASTM C423-23.

The new standard is more precise, avoiding the ambiguity inherent in C423-17. The new C423-23 also includes an additional 12" of space in the baffle array for all tests. This was not included in the previous test standard, and may cause the final NRC value to decrease slightly.

Soelberg strives to have the most precise acoustic data possible, and is the first manufacturer to adopt the new standard to our knowledge.

Please confirm that the ASTM C423-23 method was used when comparing competing products.

GRILLEZ CEILING PANELS

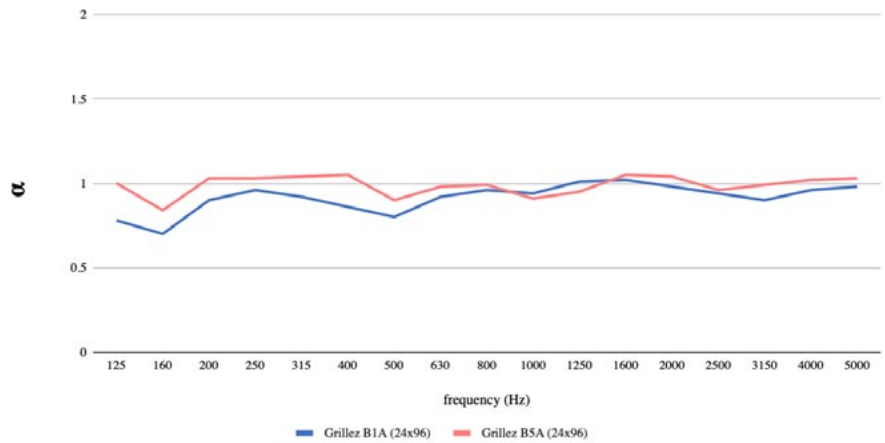

GRILLEZ CEILING PANELS

SAMPLE FREQUENCY (Hz)	SAMPLE FREQUENCY (Hz)				NRC	SAA
	250	500	1000	2000		
24x96	0.96	0.80	0.94	0.98	0.90	0.93
24x96	1.03	0.90	0.91	1.04	0.95	0.99

GRILLEZ WALL PANELS

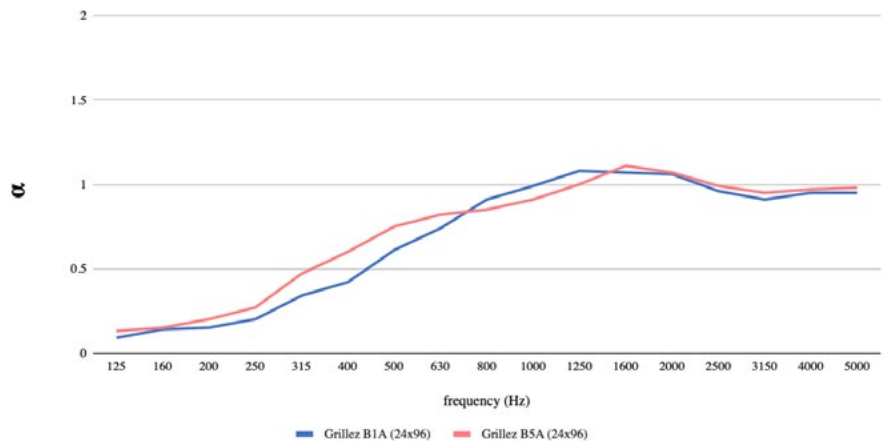

GRILLEZ WALL PANELS

SAMPLE FREQUENCY (Hz)	SAMPLE FREQUENCY (Hz)				NRC	SAA
	250	500	1000	2000		
24x96	0.20	0.61	0.99	1.06	0.70	0.71
24x96	0.27	0.75	0.91	1.07	0.75	0.75

## APPARENT NRC RATINGS

NRC values are typically used for flat surfaces of a given surface area, e.g. carpet or wall coverings. When rating hanging objects that are spread out, the 'Apparent NRC' is used.

## WHAT IS NRC?

NRC is an acronym for Noise Reduction Coefficient. This is a convenient single rating for assessing the absorbency of a material. This can be used to predict its efficacy for reducing reverberation within a room. NRC is calculated from the absorption coefficients at 125 Hz, 250 Hz, 500 Hz and 1,000 Hz, rounded to the nearest 0.05.

# ENVIRONMENTAL

## DECLARE, MINDFUL MATERIALS & GREENGUARD GOLD CERTIFIED

We care about the environment and it matters that our materials support healthy and productive interior spaces. We use innovative materials but ensure that they meet the highest level of standards and expectations.

Particleboard cores consist of 100% recycled and / or recovered fibers.

MUTO PET felt core material is 100% recyclable with no added urea formaldehyde with a minimum of 60% pre-consumer recycled content. MUTO is Declare, Mindful Materials and GreenGuard Gold certified.

**Declare.**

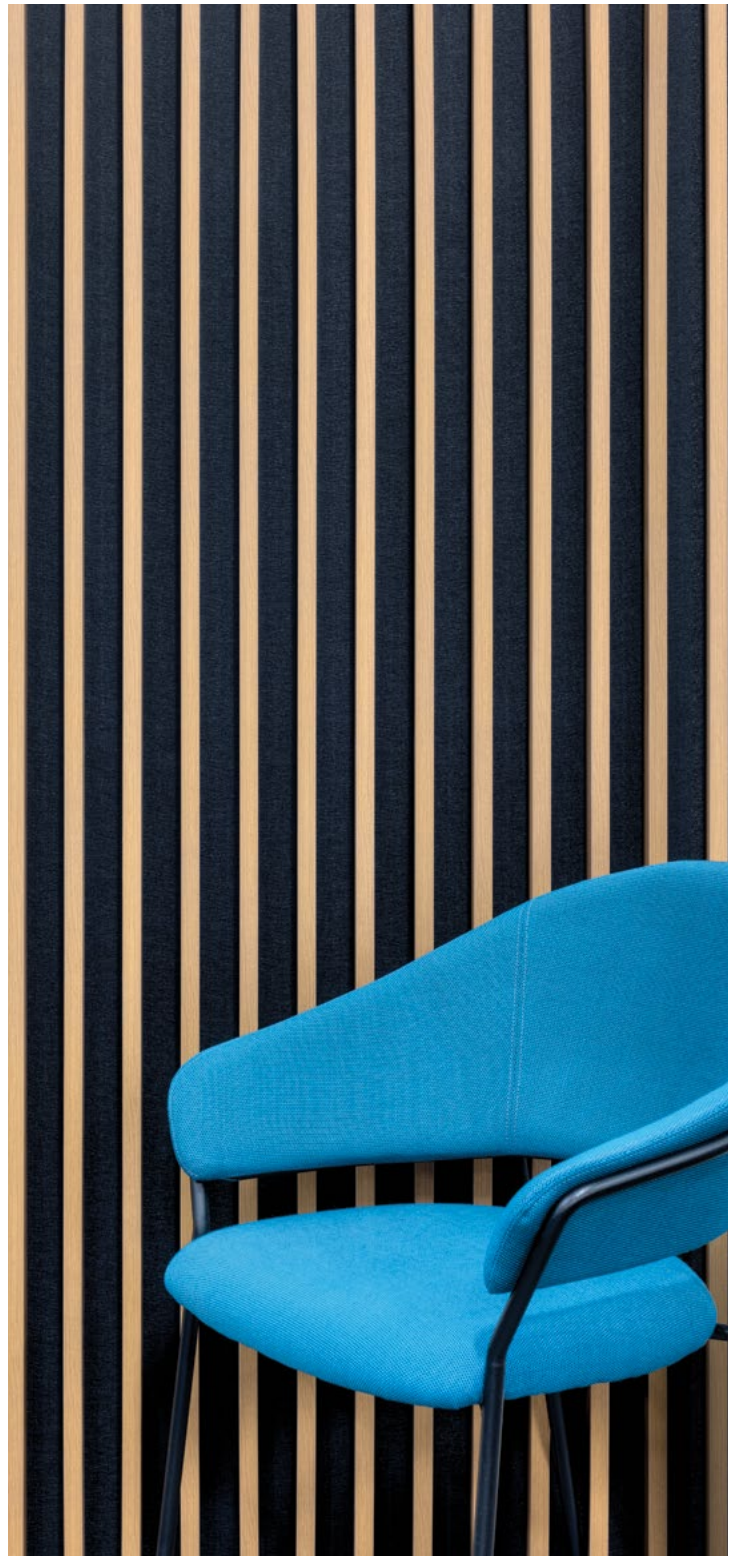

# INSTALLATION

## CEILING INSTALLATION

Direct screw attachment to T-grid is required for successful installation.

Please refer to our installation guide for coordination of attachment locations.

## WALL INSTALLATION

Direct screw attachment or the use of Zclip hardware is recommended.

Please refer to our installation guide for detailed instructions.

