

MUTO TOZZO

acoustic ceiling solutions

SOELBERG

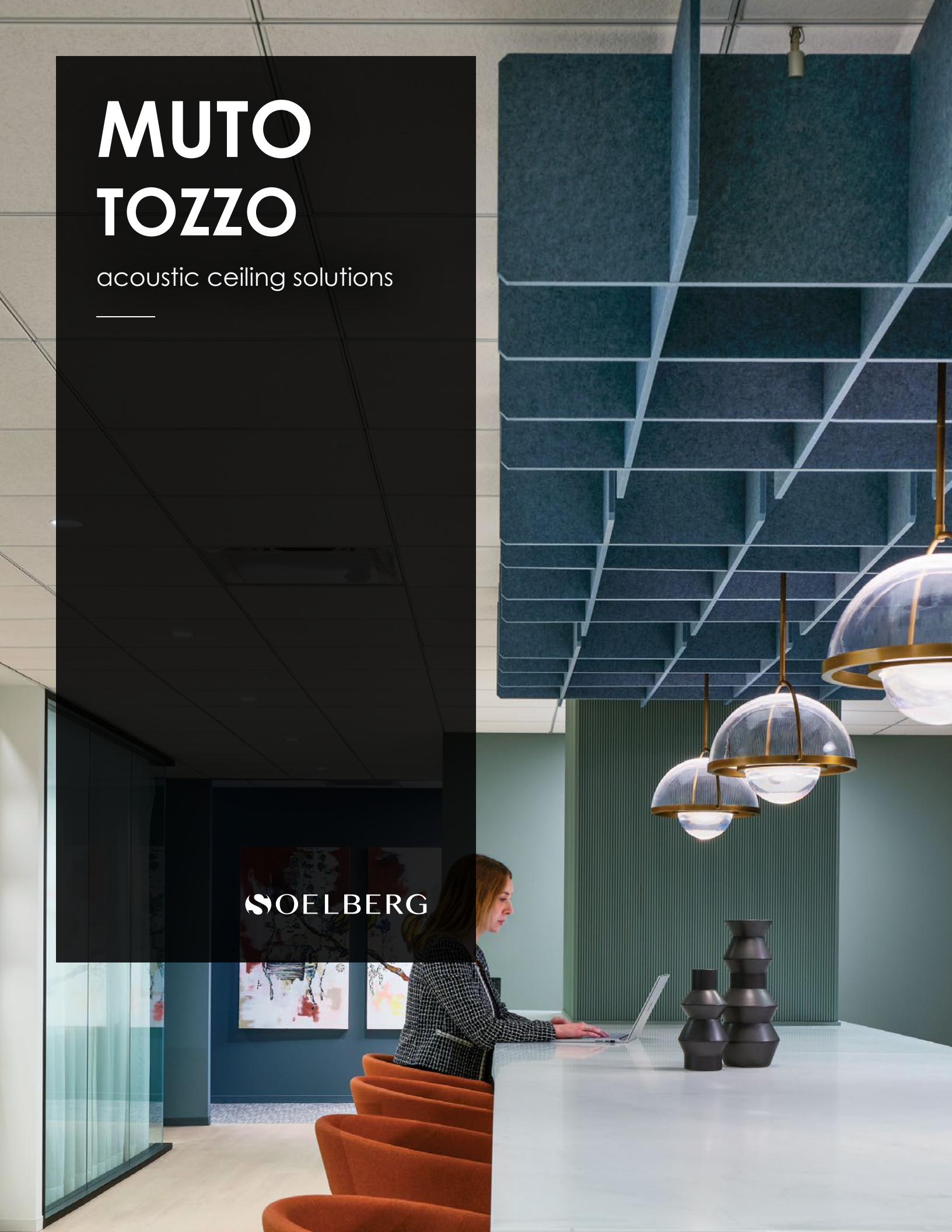

MUTO TOZZO

acoustic ceiling solutions

MUTO Tozzo offers you beautiful high-performing grids that suspend above your spaces creating texture with light and shadow. Choose from 27 colors or a variety of color combinations to make impactful sound softening ceiling statements. With our easy-to-install clip hardware and four deck connection points per grid, you can make ceilings worth looking up to. Make It Cool. Make It Quiet.

SPECIFICATION

| | |
|----------------|---|
| CONTENT | POLYESTER (PET) FELT |
| CORE THICKNESS | 1/2" (12MM) |
| LENGTH | 54" SQUARE |
| DEPTH | 11.5" |
| COLOR | 39 COLORS, WOODED & PRINT |
| HARDWARE | INCLUDED 4 CONNECTION POINTS |
| ACOUSTICS | 0.75 NRC |
| FIRE RATING | CLASS A ASTM - E84 |
| ENVIRONMENTAL | DELCARE, MINDFUL MATERIALS & GREENGUARD GOLD CERTIFIED. MUTO IS PRODUCED FROM 100% RECYCLABLE PET FELT WITH A MINIMUM OF 60% PRE-CONSUMER RECYCLED CONTENT. |
| COLORFASTNESS | IN ACCORDANCE WITH ATCC 16.3 OPTION 3 THE COLOR CHANGE TO LIGHT AT 20 AFU WAS 4.5. |
| FINISH | MATTE |
| APPLICATION | INDOOR USE ONLY |
| LEAD TIME | 2 WEEKS (STOCK & PRINT) |
| WARRANTY | 2 YEARS |

TOLERANCE & MAINTENANCE

PET core is a soft fibrous material. All dimensions and squareness are subject to +/- 1/16" tolerance.

Vacuum to remove dirt and dust. Remove spills or spots immediately using a clean damp cloth. Carpet and fabric cleaners can also be used to clean. (Always test an inconspicuous area first.) Compressed air may be used to dust in difficult or hard-to-reach areas. To disinfect, bleach can be used in accordance with CDC Cleaning & Disinfection instructions. The solution ratio is 5 tablespoons of bleach to 1 gallon of water | 4 teaspoons of bleach to 1 quart of water. Apply solution by spray and wipe off immediately. (Always test in an inconspicuous area first.)



DIMENSIONS

TOZZO GRID SIZE

SIZE: 54" SQUARE x 11.5"

HARDWARE CONNECTION: 4 ATTACHMENTS INCLUDED

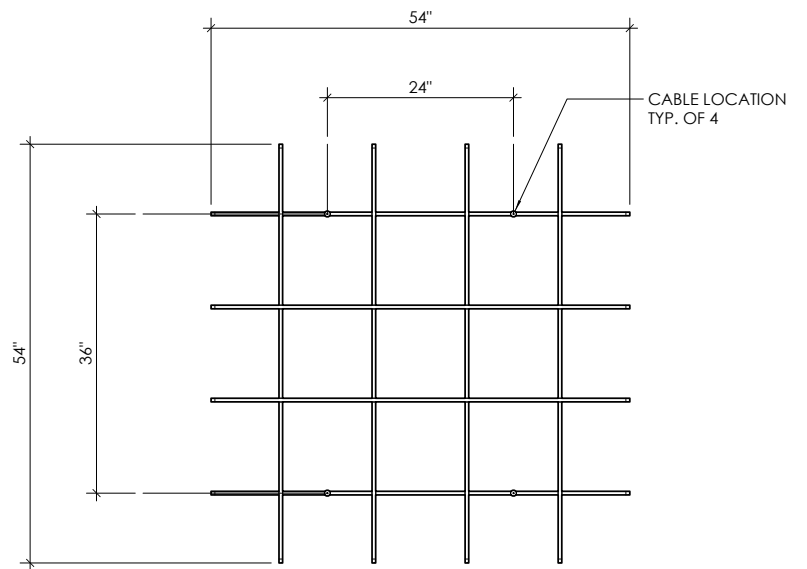

TOP VIEW
NTS

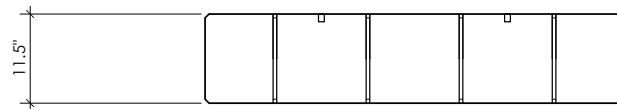

SIDE VIEW
NTS



COLOR (STOCK)

MATTE COLOR

27 STANDARD COLORS

CUSTOM PRINT COLORS AVAILABLE

(CONTACT YOUR LOCAL SALES REP)

100% RECYCLABLE PET FELT

TOLERANCES

PET felt is made from 100% recyclable polyester plastic. Variation in depth will occur. Slight and consistent variations in color, density, texture are inherent to this core material and should be expected. Color, density and texture will vary by dye lot. MUTO is made with a 'felting' process which results in a textural heathered effect where the fibers consist of multiple tones and shades.

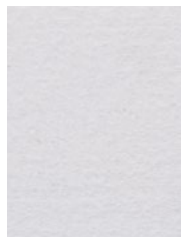

WHITE

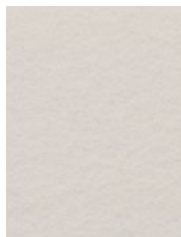

BONE

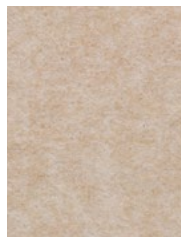

OATMEAL

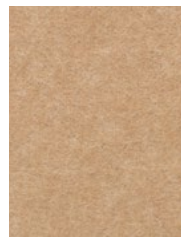

CAMEL

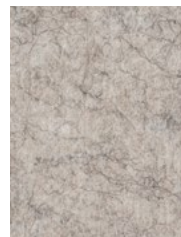

SAND



CASHMERE



FOG



LAMB'S EAR

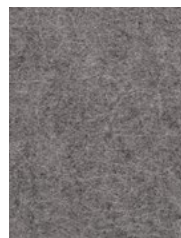

PEWTER

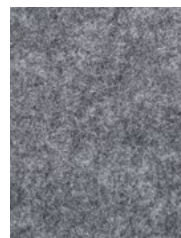

NORDIC KNIT



WINTER WATER

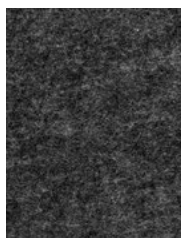

GRAPHITE



BLACK

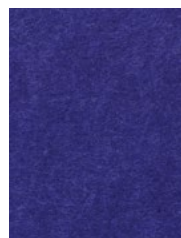

MIDNIGHT



BLUEBERRY



JUNIPER



SPLASH



STORM

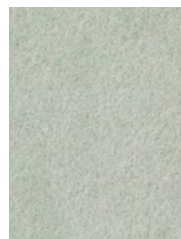

SEAFOAM

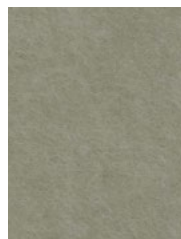

SAGE



ARTICHOKE



LICHEN

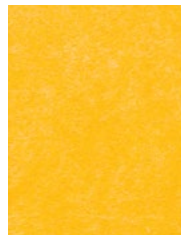

SUNSHINE

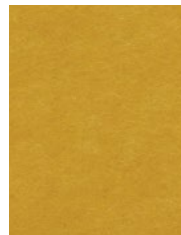

QUAKING ASPEN



CLEMENTINE

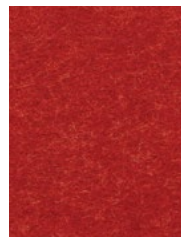

CHILI PEPPER



CURRANT

COLOR (NON STOCK)

EXTENDED LEAD TIME

MATTE COLOR

12 STANDARD NON-STOCKED COLORS
CUSTOM PRINT COLORS AVAILABLE
(CONTACT YOUR LOCAL SALES REP)
100% RECYCLABLE PET FELT

TOLERANCES

PET felt is made from 100% recyclable polyester plastic. Variation in depth will occur. Slight and consistent variations in color, density, texture are inherent to this core material and should be expected. Color, density and texture will vary by dye lot. MUTO is made with a 'felling' process which results in a textural heathered effect where the fibers consist of multiple tones and shades.

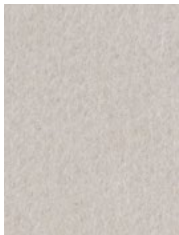

LATTE



CITY GRAY



BONDI BLUE



MARINE



WASHED DENIM

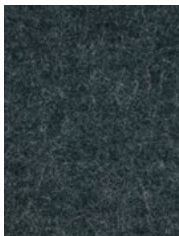

DEEP JUNGLE



COLLARD GREEN



ASPARAGUS



PECAN



SIENA



RASPBERRY



PINK LEMONADE

WOODED COLOR

MATTE FINISH

12 PRINTED WOODED GRAINS
1/2" CORE THICKNESS
100% RECYCLABLE PET FELT

TOLERANCES

PET felt is made from 100% recyclable polyester plastic. Slight and consistent variations in color, density, texture are inherent to this core material and should be expected. Color, density and texture will vary by dye lot. MUTO is made with a 'felling' process which results in a textural heathered effect where the fibers consist of multiple tones and shades.

Please request physical samples as colors are represented differently with different computer monitors.



WHITE WASHED OAK

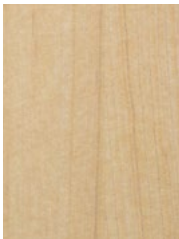

BLONDE MAPLE



NATURAL ASH



AGED ASH



SMOKED ASH

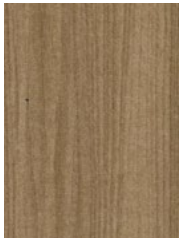

AMBER ASH



WARM WALNUT



NATURAL WALNUT



BLACK WALNUT



WEATHERED PINE



CARBON WALNUT



CHARRED OAK

PRINT COLOR

MATTE FINISH

4 PRINTED STANDARD COLORS
1/2" CORE THICKNESS
100% RECYCLABLE PET FELT
CUSTOM PRINT COLORS AVAILABLE
(CONTACT YOUR LOCAL SALES REP)

TOLERANCES

PET felt is made from 100% recyclable polyester plastic. Slight and consistent variations in color, density, texture are inherent to this core material and should be expected. Color, density and texture will vary by dye lot. MUTO is made with a 'felling' process which results in a textural heathered effect where the fibers consist of multiple tones and shades.

Please request physical samples as colors are represented differently with different computer monitors.



DESERT ROSE



DARK CLAY



RIVER



SAP GREEN

ASSEMBLY & HARDWARE

CABLE SUSPENSION

4 CONNECTION POINTS PER CLOUD INCLUDED

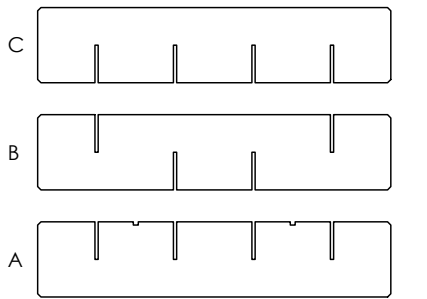

PARTS
NTS

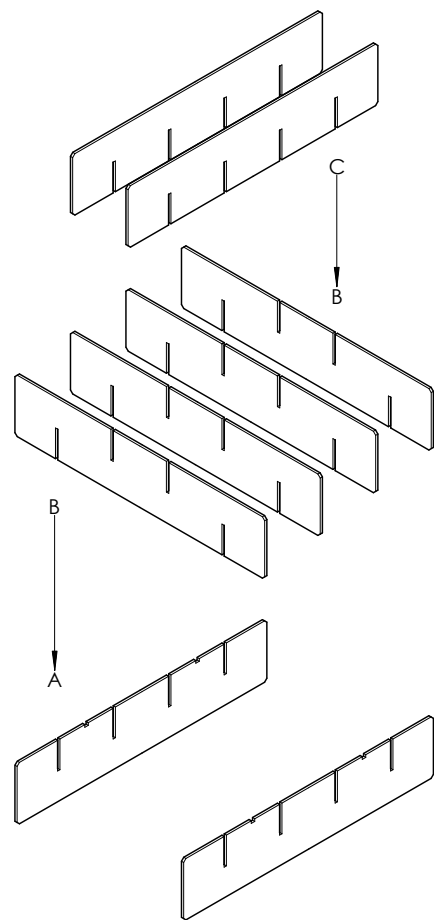

ASSEMBLY
NTS

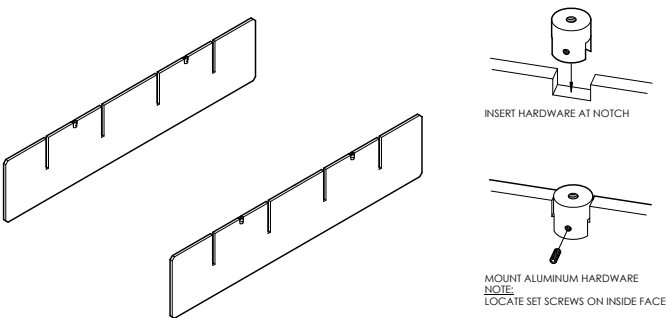

ATTACH ALUMINUM HARDWARE
NTS

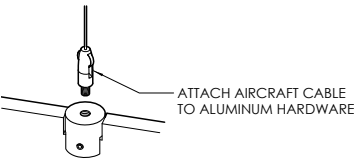

HARDWARE DETAIL
NTS

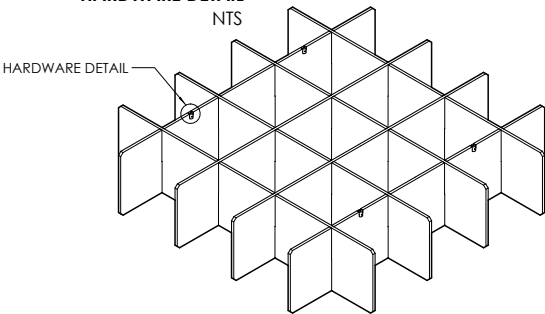

PERSPECTIVE VIEW
NTS

ACOUSTICS

APPARENT NRC RATINGS

NRC values are typically used for flat surfaces of a given surface area, e.g. carpet or wall coverings. When rating hanging objects that are spread out, the 'Apparent NRC' is used.

WHAT IS NRC?

NRC is an acronym for Noise Reduction Coefficient. This is a convenient single rating for assessing the absorbency of a material. This can be used to predict its efficacy for reducing reverberation within a room. NRC the absorption coefficients at 125 Hz, 250 Hz, 500 Hz and 1,000 Hz, rounded to the nearest 0.05.

WHY NOT STC?

STC (Sound Transmission Class) is a value used to describe the amount of sound that passes through a barrier. This can be given to a material or an entire wall assembly. If you need to assess how well a barrier can block sound between rooms you'll need to know the STC rating. Acoustic baffles are not used to physically divide rooms, but rather to absorb noise within a room. Problematic noise in a room is called reverberation. This can manifest as droning or ringing sound when people are speaking, or in the worst case: an echo. For this reason, NRC or SAA are the appropriate rating systems for treating reverberation issues.

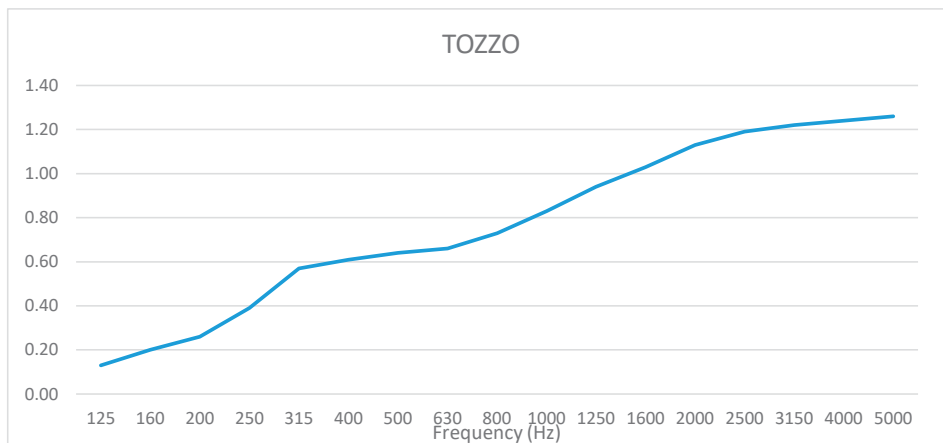

| PRODUCT | SAMPLE FREQUENCY (Hz) | | | | NRC | SAA |
|---------|-----------------------|------|------|------|------|------|
| | 250 | 500 | 1000 | 2000 | | |
| TOZZO | 0.39 | 0.64 | 0.83 | 1.13 | 0.75 | 0.75 |

ENVIRONMENTAL

DECLARE, MINDFUL MATERIALS & GREENGUARD GOLD CERTIFIED

We care about the environment and it matters that our materials support healthy and productive interior spaces. We use innovative materials but ensure that they meet the highest level of standards and expectations.

MUTO PET felt core material is 100% recyclable with no added urea formaldehyde.

Declare.

