

# TRAVE

MUTO acoustic  
wall & ceiling solutions

---

SOELBERG



# TRAVE

## MUTO acoustic wall & ceiling solutions

Take your interior from numbingly noisy to silently sophisticated with Trave. We deliver bold, acoustic style with full-scale solutions: wall-to-wall, floor-to-ceiling panels and ceiling tiles that clip directly to 15/16" T-grid systems. Trave provides a grille-style design available in warm wood grain prints or vibrant solid colors and looks as good as it absorbs sound. Fast lead times? Absolutely. Hassle-free installation? Done. Trave brings texture, tone, and transformation.

### SPECIFICATION

CONTENT	100% POLYESTER (PET) FELT
CORE THICKNESS	1/2" (12MM)
PANEL & TILE SIZE	WALL PANEL: 24" x 48"   24" x 96" OR 24" x 108" CEILING TILE: 24" x 24"   24" x 48"
BAFFLE DIMENSION	WIDTH: 1" - 4" DEPTH: 1" - 4" SPACING: 1" - 4"
COLORWAYS	27 COLORWAYS & 12 WOODED GRAINS 4 PRINT COLORS OR CUSTOM
HARDWARE	PANEL   ZCLIP SOLD SEPARATELY TILE   FACTORY APPLIED GRIDCLIP
ACOUSTICS	TESTING IN PROGRESS
FIRE RATING	CLASS A   ASTM - E84
ENVIRONMENTAL	DELCARE, MINDFUL MATERIALS & GREENGUARD GOLD CERTIFIED. MUTO IS PRODUCED FROM 100% RECYCLABLE PET FELT WITH A MINIMUM OF 60% PRE-CONSUMER RECYCLED CONTENT.
COLORFASTNESS	IN ACCORDANCE WITH ATCC 16.3 OPTION 3 THE COLOR CHANGE TO LIGHT AT 20 AFU WAS 4.5.
FINISH	MATTE
APPLICATION	INDOOR USE ONLY
LEAD TIME	2 - 4 WEEKS
WARRANTY	2 YEARS



### TOLERANCES & MAINTENANCE

PET core is a soft fibrous material. All dimensions and squareness are subject to +/- 1/16" tolerance.

Vacuum to remove dirt and dust. Remove spills or spots immediately using a clean damp cloth. Carpet and fabric cleaners can also be used to clean. (Always test an inconspicuous area first.) Compressed air may be used to dust in difficult or hard-to-reach areas.

To disinfect, bleach can be used in accordance with CDC Cleaning & Disinfection instructions. The solution ratio is 5 tablespoons of bleach to 1 gallon of water | 4 teaspoons of bleach to 1 quart of water. Apply solution by spray and wipe off immediately. (Always test in an inconspicuous area first.)

# HOW TO SPECIFY

It is easy to specify Trave with four simple steps.

# 1

## CHOOSE PANEL OR TILE AND SIZE

Select from wall panel or ceiling tile size options.

# 2

## SELECT BAFFLE & BACKER COLOR

With 27 colorways to choose from ranging from bold bright color to soft and heathered neutrals, pair with the right wood grain undertones for a perfect selection.

# 3

## CHOOSE BAFFLE SIZING & SPACING

Baffles are available in a variety of sizes (width and depth) with spacing to accommodate the size options. Standard baffles have an open end. End caps are available upon request.

# 4

## DETERMINE QUANTITY

Provide your panel or tile count or a combination for fast and easy quoting.





## COLOR

### MATTE COLOR

27 STANDARD COLORS

CUSTOM PRINT COLORS AVAILABLE

(CONTACT YOUR LOCAL SALES REP)

100% RECYCLABLE PET FELT

### TOLERANCES

PET felt is made from 100% recyclable polyester plastic. Variation in depth will occur. Slight and consistent variations in color, density, texture are inherent to this core material and should be expected. Color, density and texture will vary by dye lot. MUTO is made with a 'felling' process which results in a textural heathered effect where the fibers consist of multiple tones and shades.

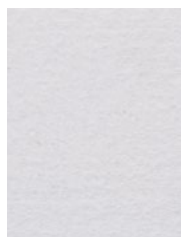

WHITE

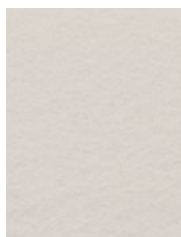

BONE

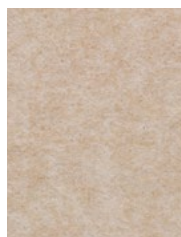

OATMEAL

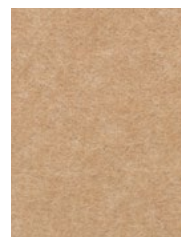

CAMEL

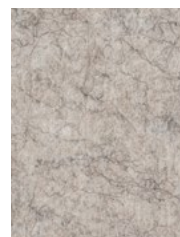

SAND



CASHMERE



FOG



LAMB'S EAR

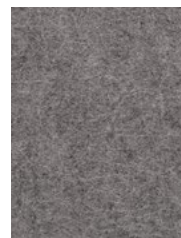

PEWTER

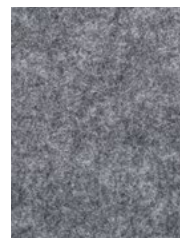

NORDIC KNIT



WINTER WATER

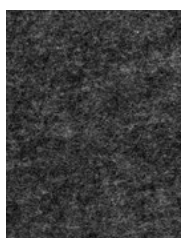

GRAPHITE



BLACK



MIDNIGHT



BLUEBERRY



JUNIPER



SPLASH



STORM

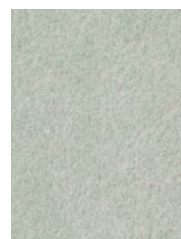

SEAFOAM

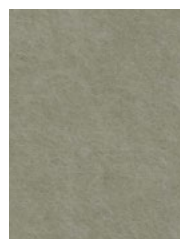

SAGE



ARTICHOKE



LICHEN



SUNSHINE

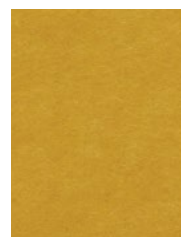

QUAKING ASPEN



CLEMENTINE

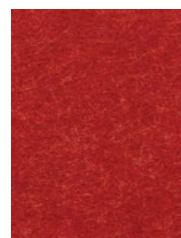

CHILI PEPPER



CURRANT

## WOODED COLOR

### MATTE FINISH

12 PRINTED WOODED GRAINS

1/2" CORE THICKNESS

100% RECYCLABLE PET FELT

### TOLERANCES

PET felt is made from 100% recyclable polyester plastic. Slight and consistent variations in color, density, texture are inherent to this core material and should be expected. Color, density and texture will vary by dye lot. MUTO is made with a 'felling' process which results in a textural heathered effect where the fibers consist of multiple tones and shades.

Please request physical samples as colors are represented differently with different computer monitors.



WHITE WASHED OAK

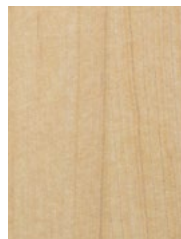

BLONDE MAPLE



NATURAL ASH

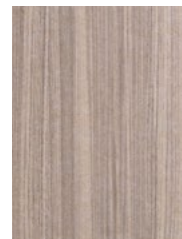

AGED ASH



SMOKED ASH

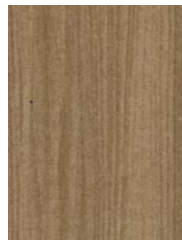

AMBER ASH



WARM WALNUT



NATURAL WALNUT



BLACK WALNUT



WEATHERED PINE



CARBON WALNUT



CHARRED OAK

## PRINT COLOR

### MATTE FINISH

4 PRINTED STANDARD COLORS

1/2" CORE THICKNESS

100% RECYCLABLE PET FELT

CUSTOM PRINT COLORS AVAILABLE

(CONTACT YOUR LOCAL SALES REP)

### TOLERANCES

PET felt is made from 100% recyclable polyester plastic. Slight and consistent variations in color, density, texture are inherent to this core material and should be expected. Color, density and texture will vary by dye lot. MUTO is made with a 'felling' process which results in a textural heathered effect where the fibers consist of multiple tones and shades.

Please request physical samples as colors are represented differently with different computer monitors.

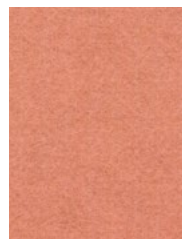

DESERT ROSE



DARK CLAY

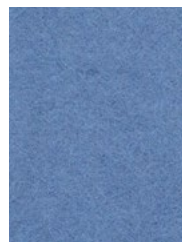

RIVER



SAP GREEN

# WALL PANEL SIZE

## PANEL DIMENSIONS

24" x 48", 24" x 96" OR 24" x 108" WITH  
STANDARD VERTICAL BAFFLES

1/2" PET BACKER WITH VARIOUS BAFFLE  
DEPTHS AND SPACING

## STANDARD BAFFLE DIMENSIONS

1" x 1" BAFFLES WITH 1" SPACING

2" x 2" BAFFLES WITH 2" SPACING

3" x 3" BAFFLES WITH 3" SPACING

3" (NOMINAL) x 4" BAFFLES WITH 3"  
(NOMINAL) SPACING

4" x 2" BAFFLES WITH 4" SPACING

\*\*\*STANDARD BAFFLES HAVE AN OPEN END.  
END CAPS ARE AVAILABLE UPON REQUEST.

## CUSTOM BAFFLE DIMENSIONS

MINIMUM BAFFLE DIMENSIONS: 1" x 0.5"

MAXIMUM BAFFLE DIMENSIONS: 4" x 4"

SPACING: THE SPACING WILL BE DETERMINED BY SELECTED BAFFLE SIZE  
AND MUST EQUAL 24"

\*\*\*END CAPS ARE AVAILABLE UPON REQUEST.

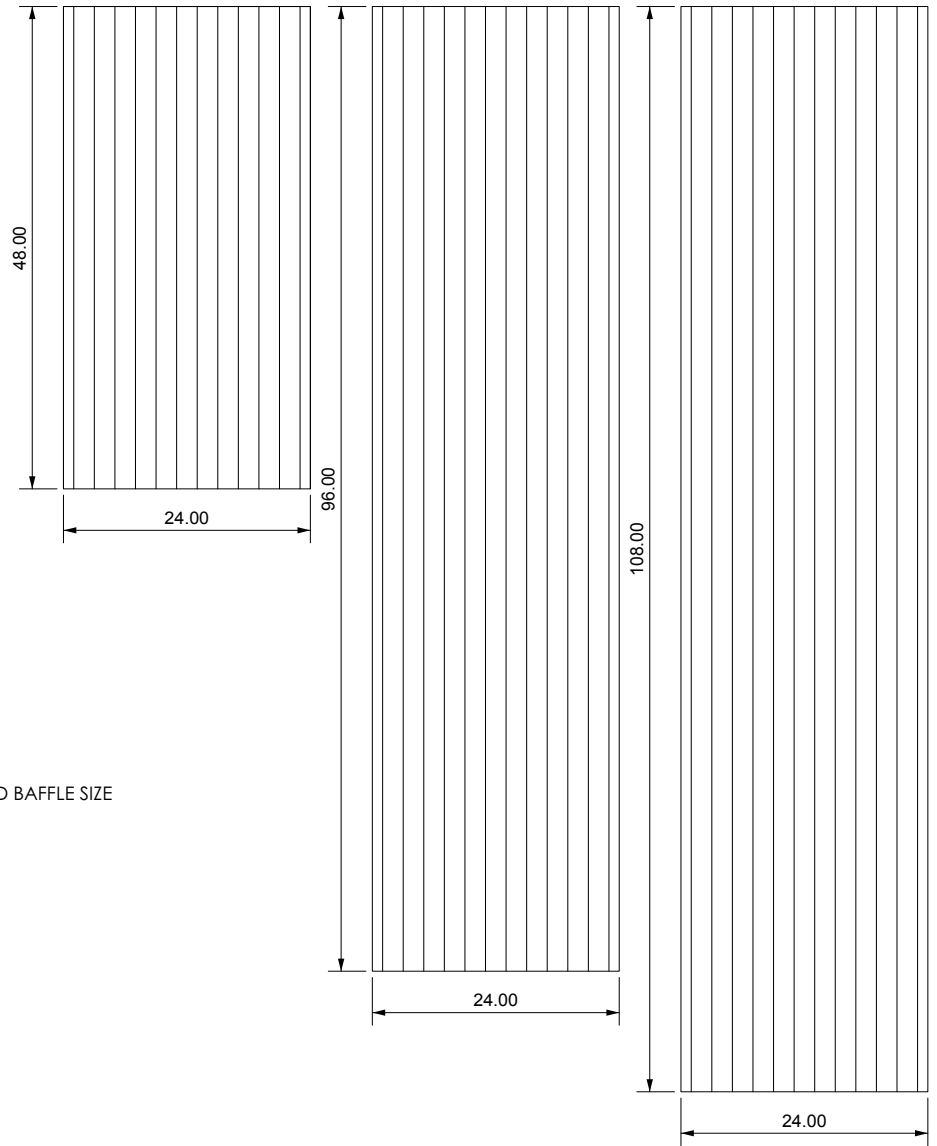

TRAVE WALL PANEL 24" x 48", 24" x 96" OR 24" x 108"

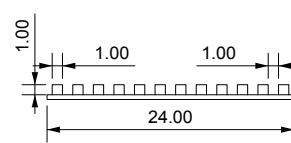

1" x 1" BAFFLES WITH 1" SPACING

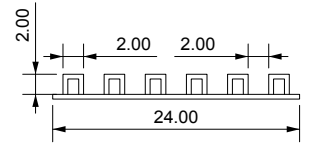

2" x 2" BAFFLES WITH 2" SPACING

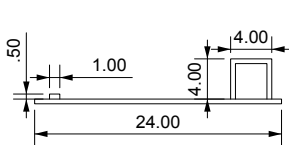

CUSTOM BAFFLE OPTIONS  
BAFFLE MINIMUM SIZE: 1" x 0.5"  
BAFFLE MAXIMUM SIZE: 4" x 4"  
SPACING MUST EQUAL 24"

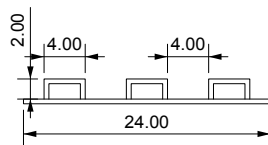

4" x 2" BAFFLES WITH 4" SPACING



3" x 3" BAFFLES WITH 3" SPACING

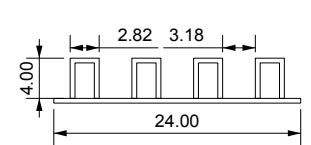

3" (NOMINAL) x 4" BAFFLES WITH  
3" (NOMINAL) SPACING

# CEILING TILE SIZE

## TILE DIMENSIONS

24" x 24" OR 24" x 48" WITH STANDARD VERTICAL BAFFLES  
1/2" PET BACKER WITH VARIOUS BAFFLE DEPTHS AND SPACING

## STANDARD BAFFLE DIMENSIONS

- 1" x 2" BAFFLES WITH 1" SPACING
  - 2" x 2" BAFFLES WITH 2" SPACING
  - 3" (NOMINAL) x 4" BAFFLES WITH 3" (NOMINAL) SPACING
- \*\*\*STANDARD BAFFLES HAVE AN OPEN END. END CAPS ARE AVAILABLE UPON REQUEST

## CUSTOM BAFFLE DIMENSIONS

MINIMUM BAFFLE DIMENSIONS: 1" x 0.5"  
MAXIMUM BAFFLE DIMENSIONS: 4" x 4" (NOMINAL)  
SPACING: THE SPACING WILL BE DETERMINED BY SELECTED BAFFLE SIZE AND MUST EQUAL 24"  
\*\*\*END CAPS ARE AVAILABLE UPON REQUEST.

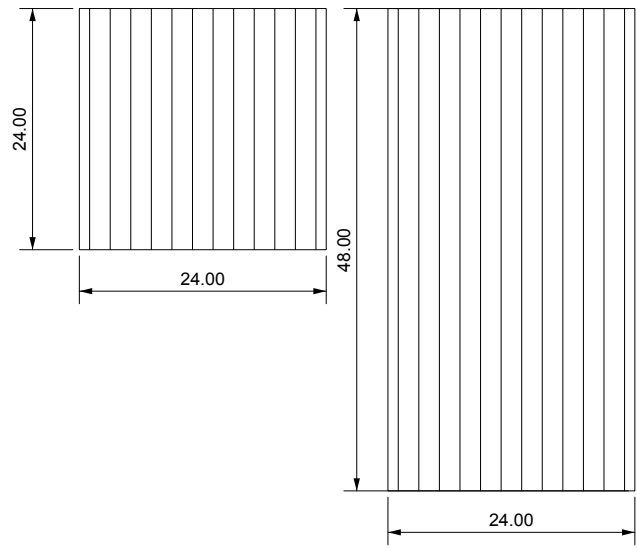

TRAVE CEILING TILE 24" x 24" AND 24" x 48"

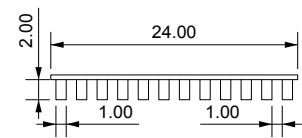

1" x 2" BAFFLES WITH 1" SPACING

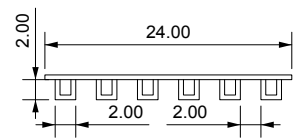

2" x 2" BAFFLES WITH 2" SPACING

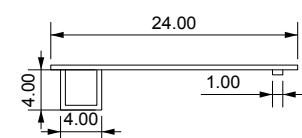

CUSTOM BAFFLE OPTIONS  
BAFFLE MINIMUM SIZE: 1" x 0.5"  
BAFFLE MAXIMUM SIZE: 4" x 4"  
SPACING MUST EQUAL 24"

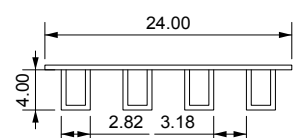

3" (NOMINAL) x 4" BAFFLES WITH  
3" (NOMINAL) SPACING

# WALL PANEL INSTALLATION & CUTTING

## INSTALLATION

### ZCLIP HARDWARE

ATTACH ZCLIP HARDWARE TO HORIZONTAL FURRING STRIPS ON THE BACK OF TRAVE PANEL WITH SCREWS THAT ACCOMMODATE THE DEPTH OF THE FURRING STRIP AND BACKER PANEL.

ATTACH ZCLIP TO THE WALL OR SUBSTRATE AT DESIRED LOCATION AND CORRESPONDS TO THE PANEL ATTACHED ZCLIP LOCATION.

FOR A FULL 96" PANEL, IT IS RECOMMENDED TO ATTACH ZCLIP AT THE TOP, BOTTOM AND CENTER OF EACH PANEL.

ZCLIP HARDWARE CREATES A 1/4" GAP BETWEEN SUBSTRATE AND PANEL.

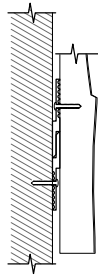
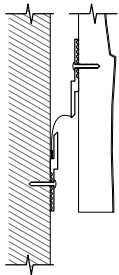

TRAVE PANELS SHOULD BE LIFTED AND PANEL ATTACHED ZCLIP HARDWARE CLIPS INTO SUBSTRATE ATTACHED HARDWARE LIKE A CLEAT.

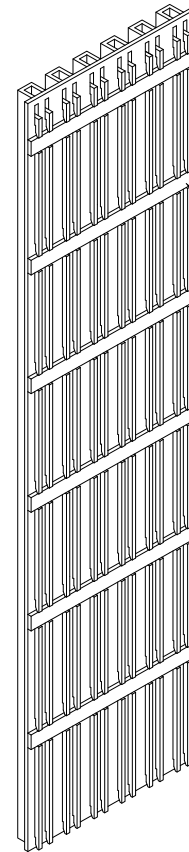

ATTACH ZCLIP HARDWARE TO HORIZONTAL FURRING STRIPS ON THE BACK OF TRAVE PANEL.

ZCLIP HARDWARE IS NOT INCLUDED AND MUST BE PURCHASED AND INSTALLED IN FIELD.

## CUTTING

TRAVE PANELS CAN BE CUT AND MODIFIED FOR VARIOUS SITE CONDITIONS. PLEASE NOTE: YOU CANNOT CUT VERTICALLY ON HOLLOW BAFFLES AS THEY WILL LOSE THEIR STRUCTURE. THEY MAY BE CUT HORIZONTALLY.

WHEN CUTTING, BE SURE TO USE SHARPENED TOOLS TO AVOID ANY OVERHEATING OF THE PET MATERIAL. A UTILITY KNIFE WITH A NEW BLADE MAY ALSO BE USED. THE FOLLOWING TOOLS ARE RECOMMENDED:

**HAND SAW** - USE A FINE TOOTHED BLADE. HOLD THE BLADE AT A LOW ANGLE AND CUT SLOWLY WITH REGULAR STROKES.

**TABLE SAW OR CIRCULAR SAW** - USE A FINE TOOTHED BLADE WITH 80 TEETH OR MORE. CARBIDE TIPPED BLADES ARE RECOMMENDED FOR EXTENSIVE CUTTING OR LARGE QUANTITY OF PANELS. ALLOW THE PANEL TO PASS THROUGH THE SAW WITH EVEN PRESSURE AVOIDING UNNECESSARY FORCE. TAKE CAUTION TO AVOID OVERHEATING THE MATERIAL WITH THE BLADE.

**JIG SAW** - USE A FINE TOOTHED BLADE SUITED FOR FINISH WOODS AND PLASTICS. IF ADJUSTABLE, USE SLOWER SPEEDS AND STEADY MOVEMENT AND PRESSURE. CAREFULLY CLAMP ALL PANELS TO AVOID VIBRATION OR MOVEMENT WHEN CUTTING AND SUPPORT THE PANEL AT ALL TIMES.

CAREFULLY MEASURE ALL WALLS TO ENSURE PROPER DIMENSIONS BEFORE CUTTING OR FABRICATING. USE BLUE TAPE BEFORE MARKING THE FACE OF A PANEL WITH PENCIL. MARKS WILL NOT ERASE FROM THE SURFACE.

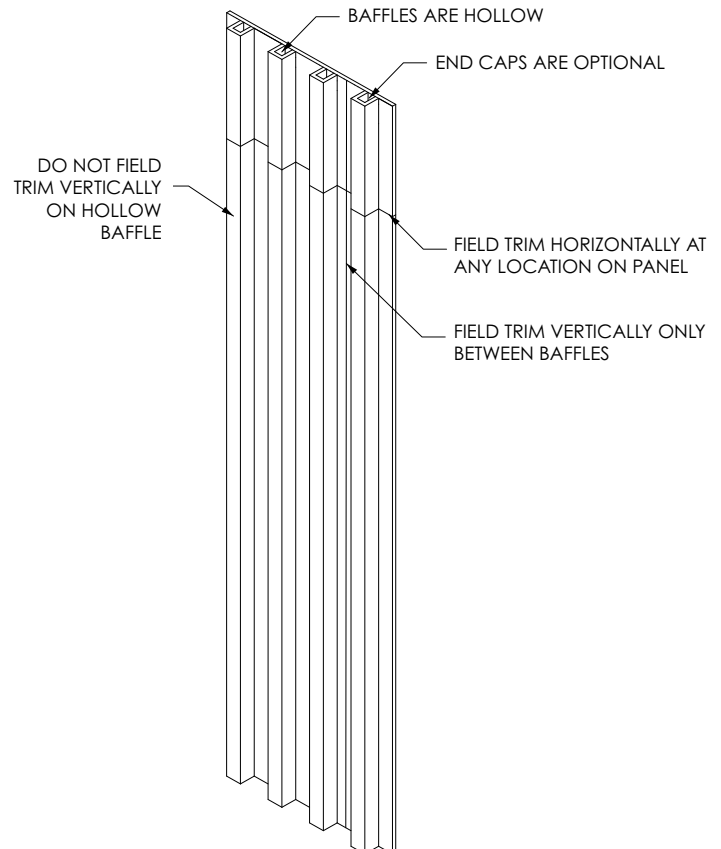



# CEILING TILE INSTALLATION & CUTTING

## T-GRID INSTALLATION

FACTORY INSTALLED GRIDCLIP HARDWARE

LIFT TILE TO T-GRID (15/16" T-GRID ONLY)

PRESS UP ON TILE UNDER EACH GRIDCLIP UNTIL THEY CLICK INTO PLACE

(SAME PROCESS FOR 24" x 24" OR 24" x 48" TILES)

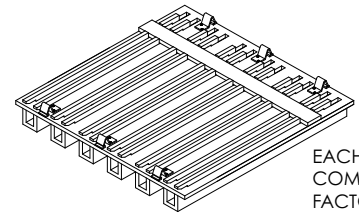

EACH TRAVE TILE COMES WITH FACTORY APPLIED GRIDCLIP HARDWARE

## CUTTING

TRAVE TILES CAN BE CUT AND MODIFIED FOR VARIOUS SITE CONDITIONS. PLEASE NOTE: YOU CANNOT CUT HORIZONTALLY ON HOLLOW BAFFLES AS THEY WILL LOSE THEIR STRUCTURE. TILES MAY ONLY BE CUT PARALLEL TO THE BAFFLES.

WHEN CUTTING, BE SURE TO USE SHARPENED TOOLS TO AVOID ANY OVERHEATING OF THE PET MATERIAL. A UTILITY KNIFE WITH A NEW BLADE MAY ALSO BE USED. THE FOLLOWING TOOLS ARE RECOMMENDED:

**HAND SAW** - USE A FINE TOOTHED BLADE. HOLD THE BLADE AT A LOW ANGLE AND CUT SLOWLY WITH REGULAR STROKES

**TABLE SAW OR CIRCULAR SAW** - USE A FINE TOOTHED BLADE WITH 80 TEETH OR MORE. CARBIDE TIPPED BLADES ARE RECOMMENDED FOR EXTENSIVE CUTTING OR LARGE QUANTITY OF PANELS. ALLOW THE PANEL TO PASS THROUGH THE SAW WITH EVEN PRESSURE AVOIDING UNNECESSARY FORCE. TAKE CAUTION TO AVOID OVERHEATING THE MATERIAL WITH THE BLADE.

**JIG SAW** - USE A FINE TOOTHED BLADE SUITED FOR FINISH WOODS AND PLASTICS. IF ADJUSTABLE, USE SLOWER SPEEDS AND STEADY MOVEMENT AND PRESSURE. CAREFULLY CLAMP ALL PANELS TO AVOID VIBRATION OR MOVEMENT WHEN CUTTING AND SUPPORT THE PANEL AT ALL TIMES.

CAREFULLY CONFIRM ALL CEILING CONDITIONS TO ENSURE PROPER DIMENSIONS BEFORE CUTTING. USE BLUE TAPE BEFORE MARKING THE FACE OF A TILE WITH PENCIL. MARKS WILL NOT ERASE FROM THE SURFACE.

UNSCREW FACTORY APPLIED GRIDCLIP HARDWARE AND RE-ATTACH AS NEEDED.

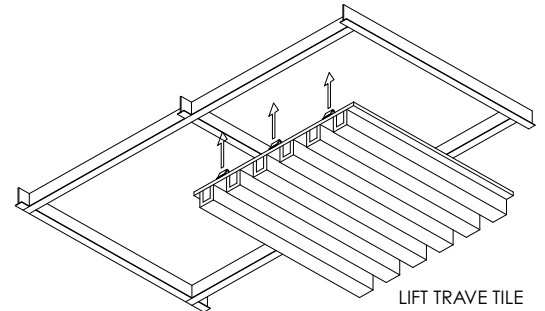

LIFT TRAVE TILE TO 15/16" T-GRID

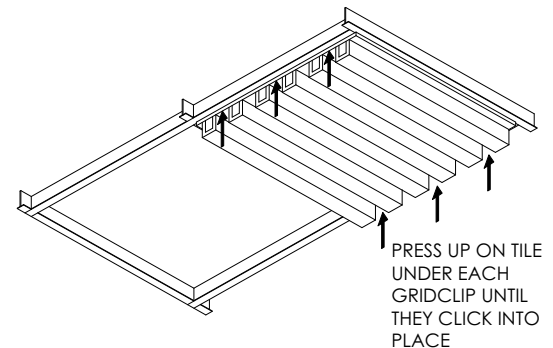

PRESS UP ON TILE UNDER EACH GRIDCLIP UNTIL THEY CLICK INTO PLACE

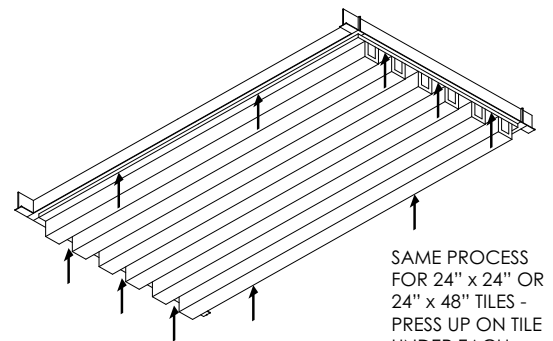

SAME PROCESS FOR 24" x 24" OR 24" x 48" TILES - PRESS UP ON TILE UNDER EACH GRIDCLIP UNTIL THEY CLICK INTO PLACE.

TO REMOVE TILES, PRESS ON THE GRIDCLIP LOCATION AND TILES WILL DROP.

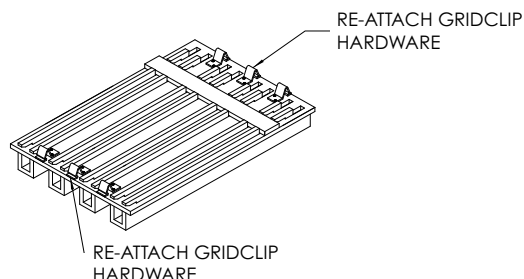
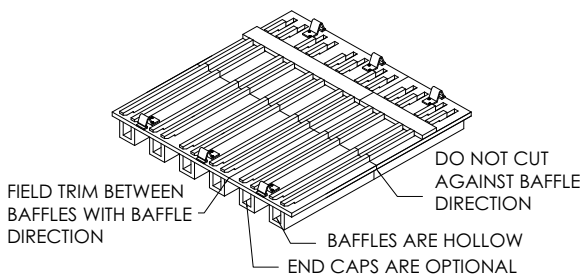

# ACOUSTICS

NRC values in the United States use the ASTM C423 for an industry wide standard for testing acoustic baffles.

The previous test: ASTM C423-17: "Standard Test Method for Sound Absorption and Sound Absorption Coefficients by the Reverberation Room Method." has been replaced in 2023 with ASTM C423-23.

This latest version removes ambiguity regarding the surface area used to calculate the NRC values.

Previous Soelberg NRC values for hanging baffles have used ASTM C423-17 with the total sound absorption divided by the total surface area of the test surface covered by the hanging baffles, including intermediate spaces. This is more conservative than other calculation methods, but is most representative of the intended use of our baffles.

As of July 2023, Soelberg has adapted all of our NRC tests to the latest method: ASTM C423-23.

The new standard is more precise, avoiding the ambiguity inherent in C423-17. The new C423-23 also includes an additional 12" of space in the baffle array for all tests. This was not included in the previous test standard, and may cause the final NRC value to decrease slightly.

Soelberg strives to have the most precise acoustic data possible, and is the first manufacturer to adopt the new standard to our knowledge.

Please confirm that the ASTM C423-23 method was used when comparing competing products.

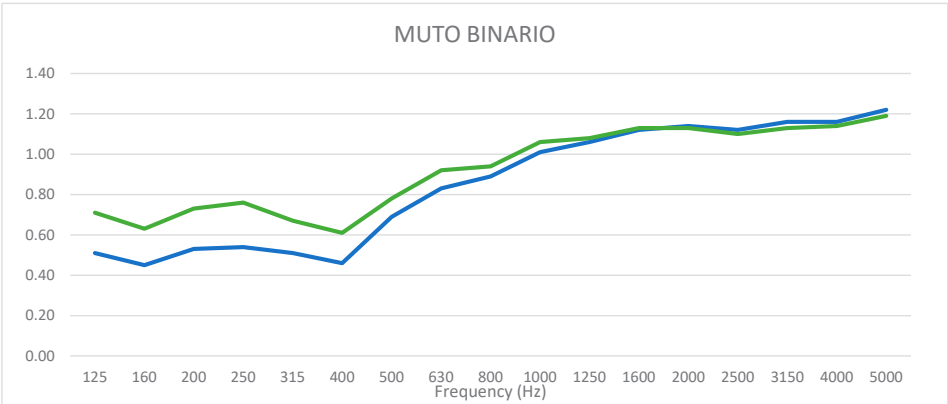

PRODUCT	MOUNTING		SAMPLE FREQUENCY (Hz)				NRC	SAA
			250	500	1000	2000		
01 (SMALL)	E400	α	0.54	0.69	1.01	1.14	0.85	0.83
02 (WIDE)	E400		0.76	0.78	1.06	1.13	0.95	0.91

\*\*\*NRC RATINGS ARE FOR BINARIO PRODUCT AND TRAVE WILL PERFORM HIGHER WITH A FULL BACKER PANEL. TRAVE TESTING IN PROGRESS.

## APPARENT NRC RATINGS

NRC values are typically used for flat surfaces of a given surface area, e.g. carpet or wall coverings. When rating hanging objects that are spread out, the 'Apparent NRC' is used.

## WHAT IS NRC?

NRC is an acronym for Noise Reduction Coefficient. This is a convenient single rating for assessing the absorbency of a material. This can be used to predict its efficacy for reducing reverberation within a room. NRC the absorption coefficients at 125 Hz, 250 Hz, 500 Hz and 1,000 Hz, rounded to the nearest 0.05.

## WHY NOT STC?

STC (Sound Transmission Class) is a value used to describe the amount of sound that passes through a barrier. This can be given to a material or an entire wall assembly. If you need to assess how well a barrier can block sound between rooms you'll need to know the STC rating. Acoustic baffles are not used to physically divide rooms, but rather to absorb noise within a room. Problematic noise in a room is called reverberation. This can manifest as droning or ringing sound when people are speaking, or in the worst case: an echo. For this reason, NRC or SAA are the appropriate rating systems for treating reverberation issues.

# ENVIRONMENTAL

## DECLARE, MINDFUL MATERIALS & GREENGUARD GOLD CERTIFIED

We care about the environment and it matters that our materials support healthy and productive interior spaces. We use innovative materials but ensure that they meet the highest level of standards and expectations.

MUTO PET felt core material is 100% recyclable with no added urea formaldehyde.

Declare.

